

TX7142

Intelligent Manual Call Point Installation and Operation Manual



Product Safety

To prevent severe injury and loss of life or property, read the instruction carefully before installing the manual fire alarm call point to ensure proper and safe operation of the system.



European Union directive

2012/19/EU (WEEE directive): Products marked with this symbol cannot be disposed of as unsorted municipal waste in the European Union. For proper recycling, return this product to your local supplier upon the purchase of equivalent new equipment, or dispose of it at designated collection points.



For more information please visit the website at www.recyclethis.info

Table of Content

1 Introduction 4

 1.1 Overview 4

 1.2 Feature and Benefits 4

 1.3 Technical Specification 4

2 Installation 4

 2.1 Installation Preparation 4

 2.2 Installation and Wiring 4

 Figure 1 5

 Figure 2 5

 Figure 3 6

3 Manual fire alarm call point Configuration 6

 3.1 Preparation 6

 3.2 Addressing 6

 3.3 Read Configuration 7

4 General Maintenance 7

 4.1 Resetting Manual Call Point 7

5 Troubleshooting Guide 7

Appendix 1 8

 Limitation of Manual fire alarm call point 8

1 Introduction

1.1 Overview

The TX7142 manual fire alarm call point use a non-breakable plastic which is designed to press under pressure triggering the point into an alarm condition, with LED indicators mounted onto the front face to simplify the location of an operated point. Safe to press and no hammer is required. The protected flap on the lower part is used for reset through supplied special tool.

In the event of fire, once it is pressed, the LED on the left of the point goes on indicate the status of the point and parallel sending communication signal to the control panel.

1.2 Feature and Benefits

- Using microprocessor technology
- Digital addressing
- Non-breakable plastic and hammerless
- Safe to operate and easy to reset
- Indoor application

1.3 Technical Specification

- | | |
|-----------------------------|---|
| • Input Voltage | 24VDC [16V to 28V] |
| • Current Consumption | Standby :0.65mA, Alarm: 1.00mA |
| • Protocol/Addressing | T&A, Value range from 1 to 254 |
| • Indicator | Alarm LED / Steady On-when pressed. Periodically flash during patrol inspection Flashing cycle: about 6 s.
Tel LED/ Periodically flash when connected to the telephony Bus,flashing cycle: about 14 s. |
| • Material / Colour | ABS / RED |
| • Dimension | 90 mm x 90 mm x 34 mm |
| • Weight | 93g (with Base) |
| • Operating Temperature | -10°C to +55°C |
| • Ingress Protection Rating | IP43 |
| • Humidity | 0 to 95% Relative Humidity, Non condensing |

2 Installation

2.1 Installation Preparation

This manual fire alarm call point must be installed, commissioned and maintained by a qualified or factory trained service personnel. The installation must be installed in compliance with all local codes having a jurisdiction in your area.

2.2 Installation and Wiring

1. Before installing the equipment, it is necessary to cut off the power supply of the circuit and confirm that all the bottom shells have been installed firmly and that the connecting wires of each bottom shell are correct.
2. Fix the base of the manual fire alarm call point to wall as shown in Figure 1. Follow the arrow mark for the correct position. Do not over-tighten the screws otherwise the base will twist.
3. Connect the wire in terminal as shown in Figure 2. Verify the device number using handheld programmer then stick on the label before attaching the call point. The sticker labels are available on the control panel.
4. Align the call point and tabs and gently pushing the call point until it locks into place.
5. The manual fire alarm call point base and the front cover are pluggable., which can be separated by using a 3.5mm slotted screwdriver as shown in Figure 3.

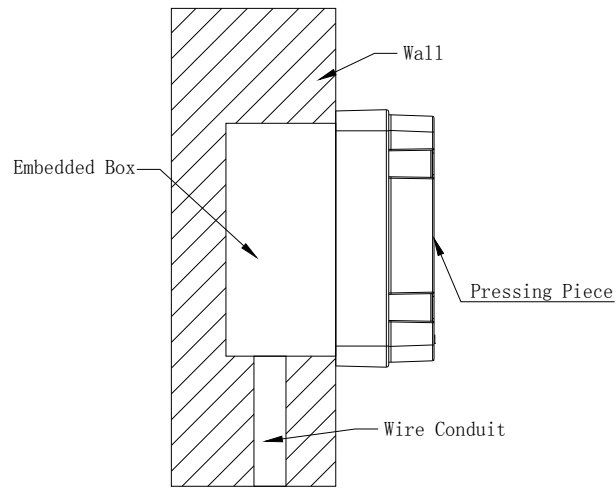

Figure 1

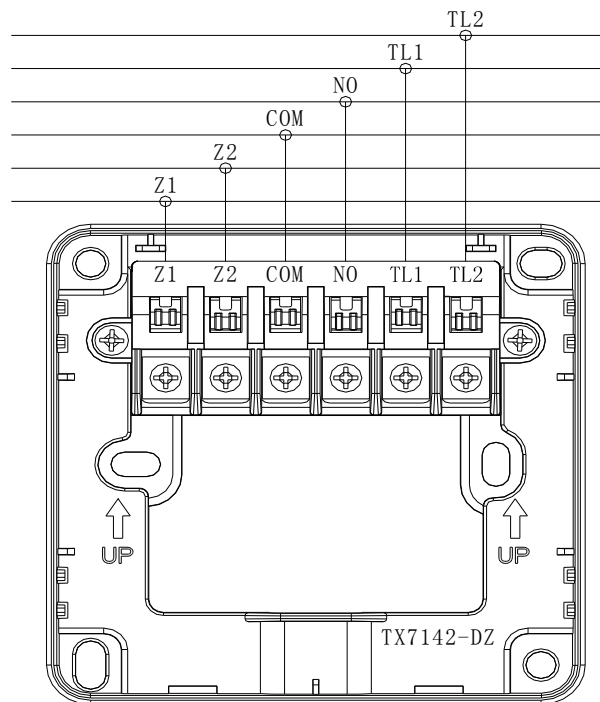

Figure 2

Z1/Z2: Connection with signal bus, nonpolarity.

NO/COM: DC30V/100mA output terminal. Can output signal to control the external device, when the button is pressed.

TL1+/TL2-: Connection with the telephony bus, nonpolarity.

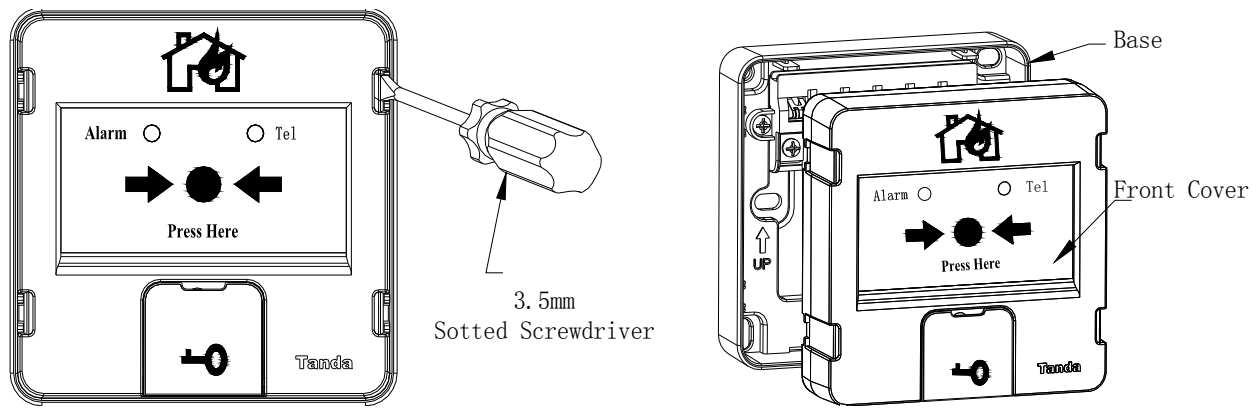

Figure 3

3 Manual fire alarm call point Configuration

3.1 Preparation

The handheld programmer is used to configure the soft address of manual fire alarm call point. This tool is not included, must be purchased separately. The programmer is packed with twin 1.5V AA battery and cable, ready for usage once received.

Program a unique address number for each device according to the project layout before placing from the terminal base.

Warning: Disconnect the loop connection whilst connecting to the handheld programmer.

3.2 Addressing

1. Connect the programming cable to Z1 and Z2 terminals of manual fire alarm call point. Press **"Power"** to switch on the unit.
2. Switch-on the programmer, then press button **"Write"** or number **"2"** to enter Write Address mode (Figure 4).
3. Input the desire device address value from 1 to 254, and then press **"Write"** to save the new address (Figure 5).

Note: If display **"Success"**, means the entered address is confirmed. If display **"Fail"**, means failure to program the address (Figure 6).

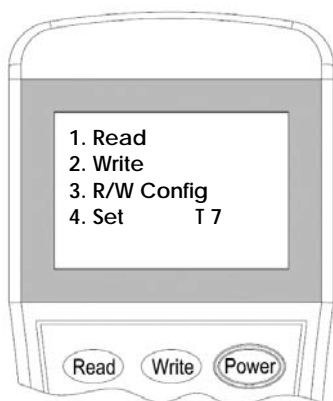

Figure 4



Figure 5



Figure 6

4. Press **"Exit"** key to go back Main Menu. Press **"Power"** key to switch-off the programmer.

3.3 Read Configuration

1. Attach the programming cable to Z1 and Z2 terminals of manual fire alarm call point. Press **"Power"** to switch on the unit.
2. Switch-on the programmer, then press button **"Read"** or **"1"** to enter to Read mode (Figure 7). The programmer will display the configuration after few seconds (Figure 8).
3. Press **"Exit"** key to go back Main Menu. Press **"Power"** key to switch off the programmer.

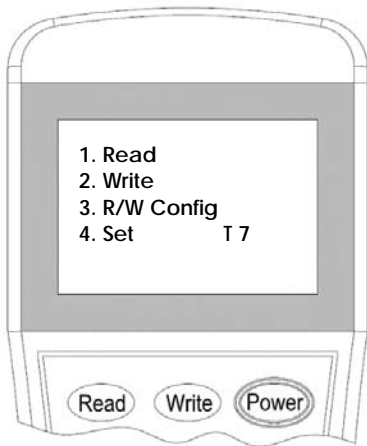

Figure 7

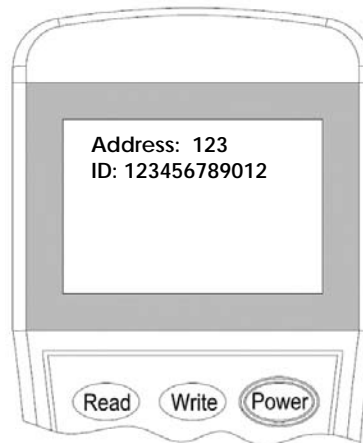

Figure 8

Read Description

Address: Unique number assigned

ID: Device serial number

4 General Maintenance

1. Inform the suitable personnel before conducting the maintenance.
2. Disable the manual fire alarm call point on the control panel to prevent false alarm.
3. Do not attempt to adjust or modify the manual fire alarm call point, it may affect the ability of the device to respond to a fire condition and will void the manufacturer's warranty.
4. Use a damp cloth to clean the call point.
5. Notify again proper personnel after conducting the maintenance and make sure to enable the manual fire alarm call point and confirm if up and running.
6. Perform the maintenance on semi-annually or quarterly depending on the site conditions.

4.1 Resetting Manual Call Point

1. Ensure the fire is cleared before resetting the call point.
2. Open the protected flap and insert the supplied reset key into the key hole.
3. Rotate the key clockwise position up to 90-degree angle. Then forcibly push the key inside until the plastic plate completely return to its normal position.
4. The manual fire alarm call point resets the product program after receiving the reset command from the mainframe.

5 Troubleshooting Guide

What you notice	What it means	What to do
Address not enrolling	The wiring is loose The address is duplicate	Conduct maintenance Re-Commission the call point
Unable to commission	The damage the electronic circuit	Replace the call point unit
Unable to press or reset	The damage mechanical part	Replace the call point unit

Appendix 1

Limitation of Manual fire alarm call point

The manual fire alarm call point cannot last forever. In order to keep the start button working in good condition, please maintain the equipment continuously according to recommendations from manufacturers and relative nation codes and laws. Take specific maintenance measures on the basis of different environments.

This device contains electronic parts. Even though it is made to last for a long period of time, any of these parts could fail at any time. Therefore, test your manual fire alarm call point weekly, different one once a week or least every half-year according to national codes or laws. Any manual fire alarm call points or any other components of the system must be repaired and/or replaced immediately as they fail.